

PORTABLE AND LIFTABLE BASKETBALL GOALS TP SPORT

REF. BTRS201-203

GENERAL OUTLINE OF THE COMPONENTS OF THE BASKETBALL GOAL

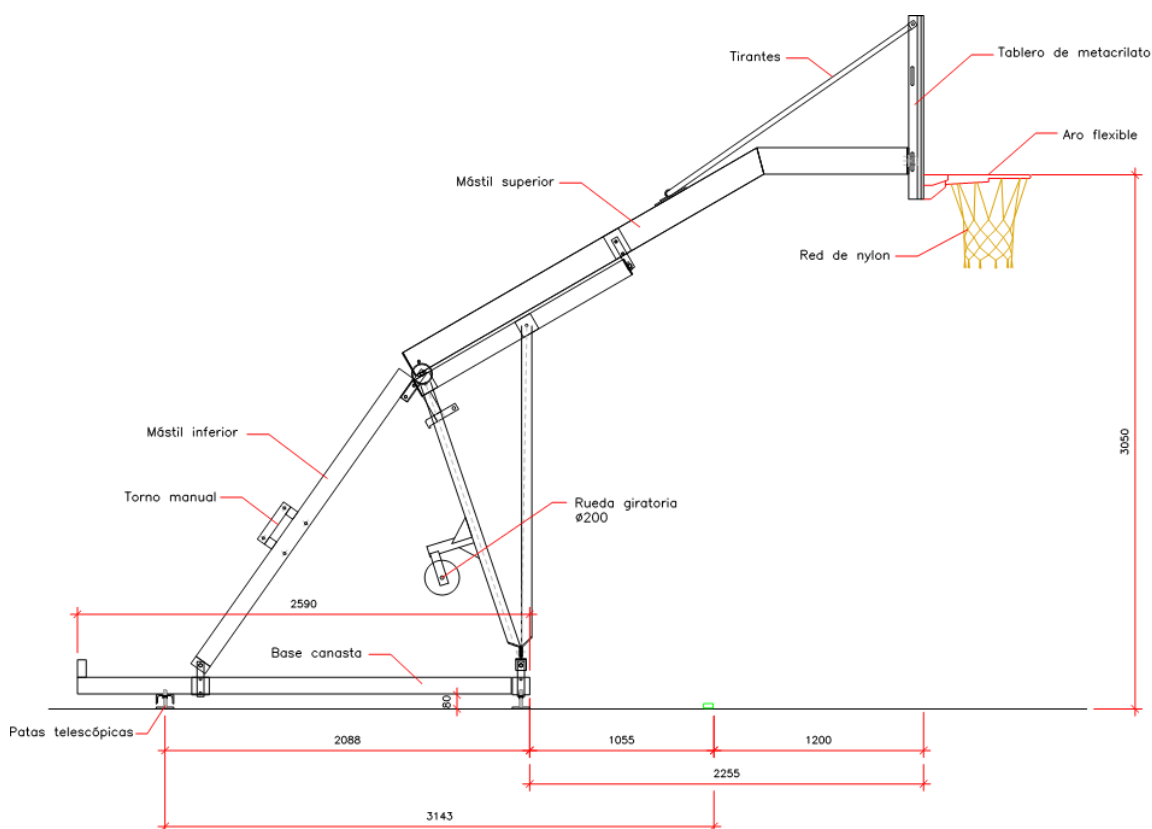

DESCRIPTION

Basketball goal set TP Sport with extension 2250m

Manufactured as per norm UNE EN 1270:2006. Easily portable through 2 front wheels with 200mm diameter and one rear rotational telescopic wheel. Once basketball goal is set, these wheels are elevated and so the basketball goal is supported by four telescopic legs with protected nonslip rubber.

Central mast made of profile steel type S -235 - JOH sufficiently dimensioned to withstand the movement of the backboard and the ring.

It includes two front and rear pillars linked by rotational hinges to the horizontal mast avoiding unnecessary movements. Finished with a degreasing treatment through a phosphate bath and painted with in polyester powder paint in the oven at 200 ° C, with a minimum thickness of 70-80 microns.

Methacrylate backboard of 1800 x 1050 with the possibility of different thicknesses, with the perimeter and rectangle shot marked with special white paint. Special central anchorage to attach the flexible ring to the metal reinforcement frame, according to DIN 7899.

Reinforced metal frame 1800 x 1050 made of cold-rolled steel, with angles 50 x 50 with slots for its installation to the support of the structure of the basket, allowing levelling. It incorporates a flexible ring with springs and with metal anti-injury attachments and with a reinforced plate as per DIN 7899 standard

Competition net made of braided cotton